

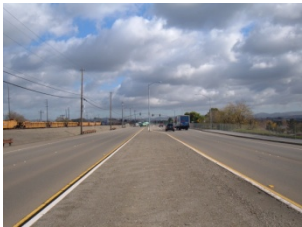

Stanley Boulevard Utility Undergrounding and Streetscape Improvement



Existing conditions on Stanley Boulevard. (Above ground utilities, and medians with no landscaping)

Project Description

Alameda County Public Works Agency is currently designing the Stanley Boulevard Utility Undergrounding and Streetscape Improvement Project between the City Limits of Pleasanton and Livermore in the unincorporated area of Alameda County. The project proposes to improve pedestrian and bicyclist access as well as improve the visual aesthetics along this roadway. Project elements include undergrounding the existing aerial utilities, reconstructing the existing median to incorporate landscaping (trees & ground cover), constructing a multi-use path along the south side of the roadway with landscaping amenities, modifying existing highway lighting and traffic signal systems, and pavement reconstruction and overlay in appropriate areas to accommodate these improvements. Also, drainage inlets and subsurface roadway drainage facilities will be constructed to improve roadway drainage.

Project Objective

To improve pedestrian and bicyclist access as well as improve the visual aesthetics along this roadway corridor.

Project Features

- Project Length: (approximately) 3 miles
- Construct a multi-use pathway along the South side of Stanley Boulevard
- Widen Shoulders to include a bicycle lane on both sides of the roadway
- Landscape along the median area and both sides of the roadway

Project Cost/Funding

	Estimated Construction Cost
Utility Undergrounding	\$5.5 M
Streetscape & Roadway Improvements	\$10 M

Project Status

- CEQA process completed January 2009
- Alameda County Board of Supervisors approved Resolution of Intention to Establish Utility Underground District #18 (UUD 18) - January 13, 2009
- Board of Supervisors conducted Public Hearing and approved first reading of the Utility Underground District No. 18 Ordinance – February 10, 2009
- County is developing streetscape and roadway improvement construction plans

Project Schedule

- Board of Supervisors will hear and approve second reading of the Utility Underground District No. 18 Ordinance – March 3, 2009
- PG&E, Comcast, & AT&T to commence design of undergrounding their facilities (TBD)
- PG&E, Comcast, & AT&T to underground facilities (TBD)
- Streetscape Improvement Project advertisement (TBD)

How to Reach Us

For additional information on this Alameda County Public Works Agency project, call James Chu at (510) 670-5566 or Bond Ng at (510) 670-5785.

Acronym: CEQA = California Environmental Quality Act

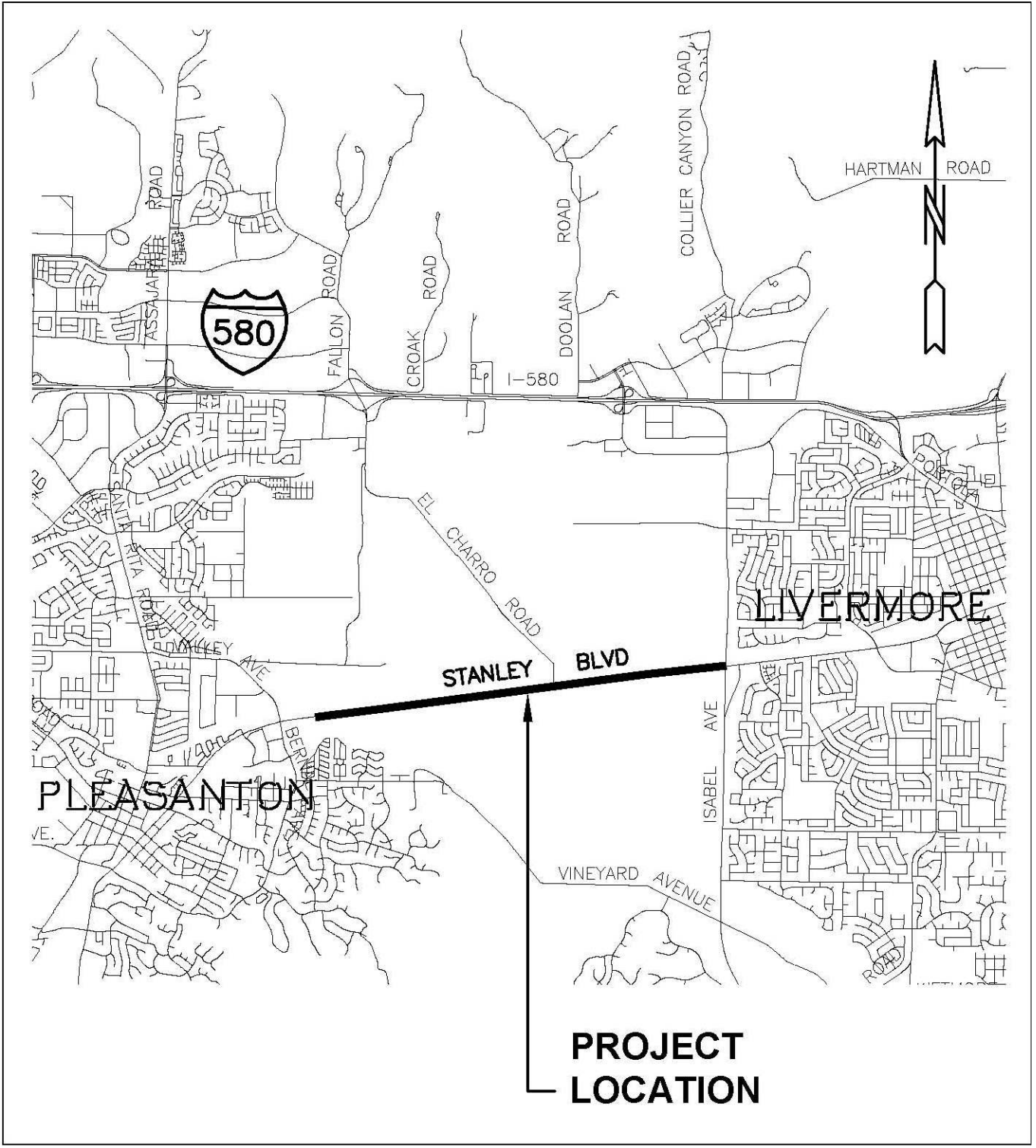

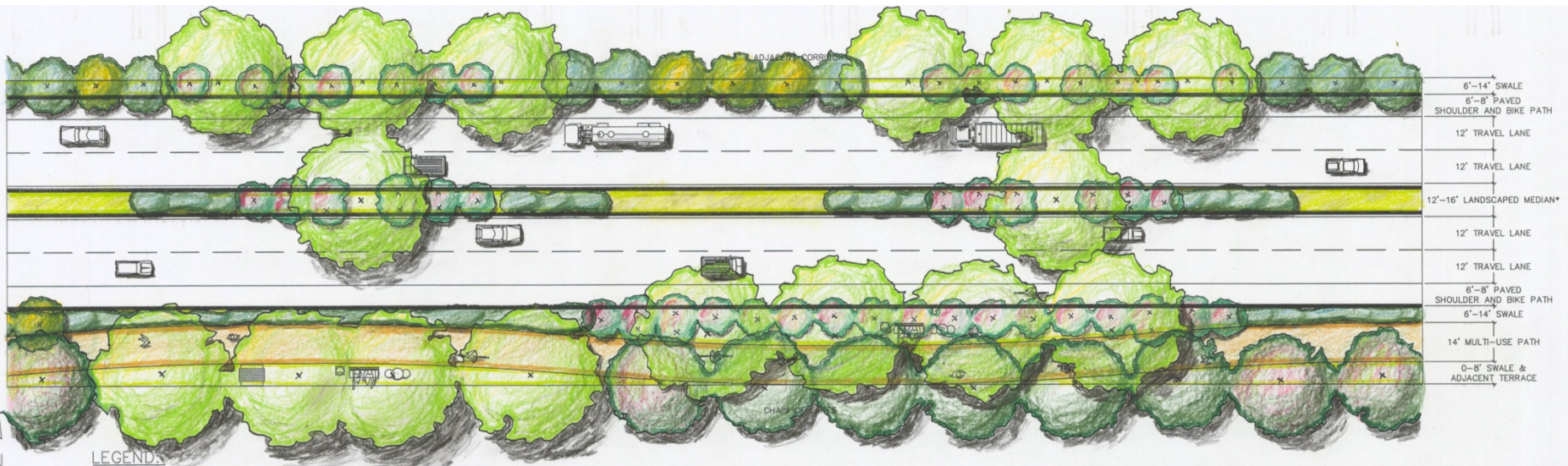

- LEGEND**
- TRASH RECEPTACLE
 - BENCH
 - PEDESTRIAN LIGHT (SOLAR POWERED)
 - EXERCISE STATION

PLAN VIEW - STANLEY BOULEVARD (110 FEET RIGHT OF WAY)
NOT TO SCALE

CONCEPTUAL PLAN ONLY
Subject to Revision
NOT TO BE USED FOR CONSTRUCTION PURPOSES

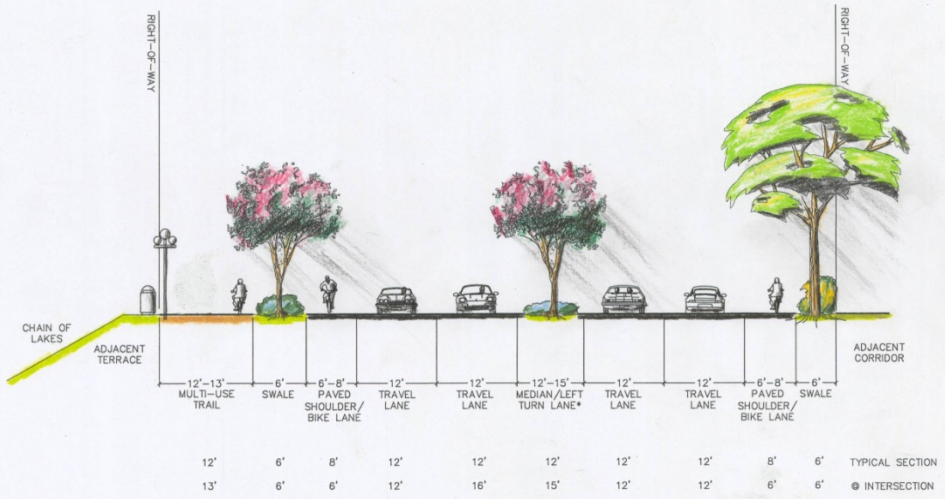

TYPICAL SECTION - 100 FEET RIGHT OF WAY
NOT TO SCALE

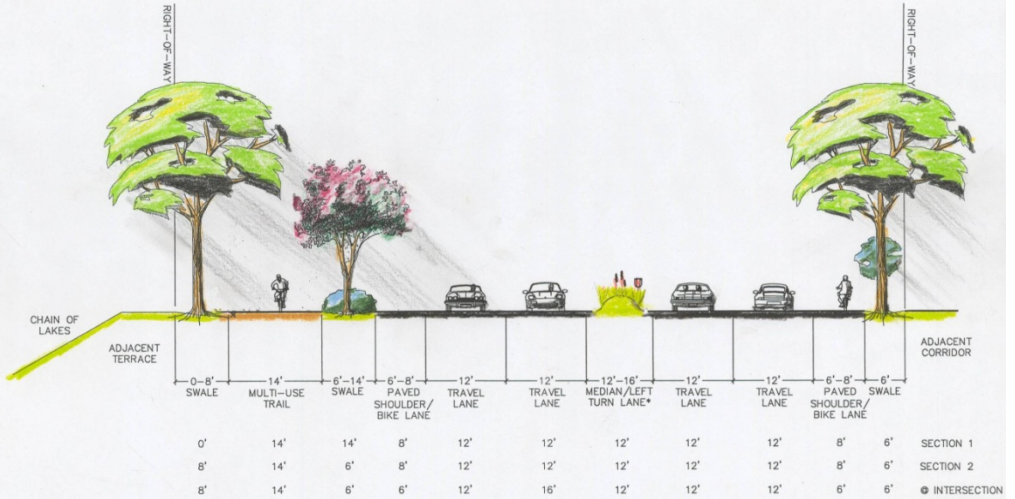

TYPICAL SECTION - 110 FEET RIGHT OF WAY
NOT TO SCALE

* INCLUDES 1.5' PAVED SHOULDERS ON BOTH SIDES OF MEDIAN

* INCLUDES 1.5' PAVED SHOULDERS ON BOTH SIDES OF MEDIAN